

TILLAMOOK COUNTY SURVEYORS OFFICE  
COURTHOUSE, TILLAMOOK, OREGON 97141

W 1/16 CORNER SECTION 31 T.3N., R.9W., W.M.  
AND SECTION 6 T.2N., R.9W., W.M.

S 31 T3NR9W I found a 3/4" iron pipe with a 3" Crown-Zellerbach  
. W 1/16 Brass Cap, (see T.C.S. Map #A-1850).  
S 6 T2NR9W I encased the found monument in a 10" concrete  
1968 cylinder.

-----  
History of found monument

I found this monument to be as described on said T.C.S. Map and the references found and/or set at that time to now be as follows:

\*10" hemlock S.72 W. 27.2'; (Found, now 16" hemlock 26.77' to a finish nail with a brass washer in the partially healed face. Scribing visible).

\*5" alder N.47 E. 6.3'; (Found, now a 9" alder leaning downhill with stretched scribing visible N.34 E. 6.19' to a finish nail with a brass washer).

-----  
References of Record

A-1850	Nov. 1968	Charles G. Collard	LS 376
B-1280	June 1987	Allan E. Duncan	LS 793
B-1283	June 1987	Allan E. Duncan	LS 793

-----  
New Accessory

\*84" light hat section post North 1.5';

-----  
Location of Monument

This corner is located approximately 150' North of a landing on the Northerly slope of a hillside.

In the presence of Al Dvorak and Dan McNutt

September 19, 1991

Title:

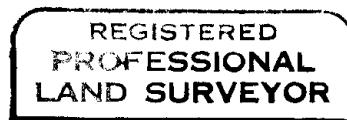
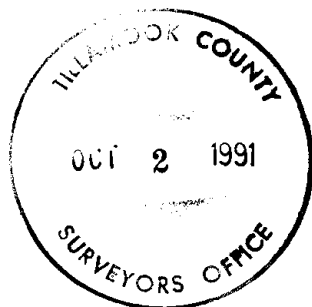

*Allan E. Duncan, C.S.*

